

Calibre 888 Seconde au centre

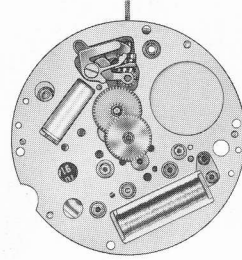

Calibre 888/31 Calendrier à bague correcteur rapide

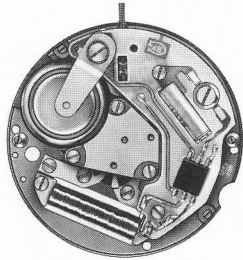
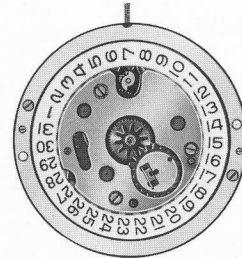
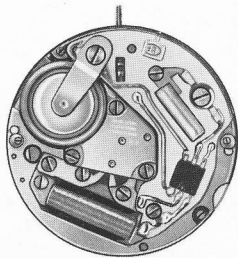

Indicateur \varnothing 26,0 mm

Calibre 888 31/7 Calendrier Day and Date correcteur rapide

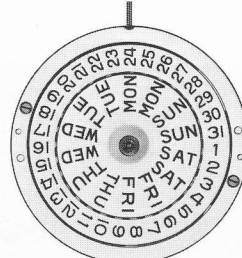
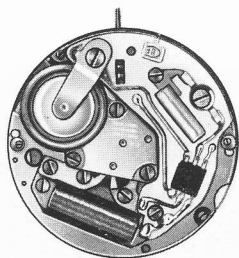

Indicateur \varnothing 26,0 mm

Disque des jours \varnothing 19,2 mm

Cal. 888

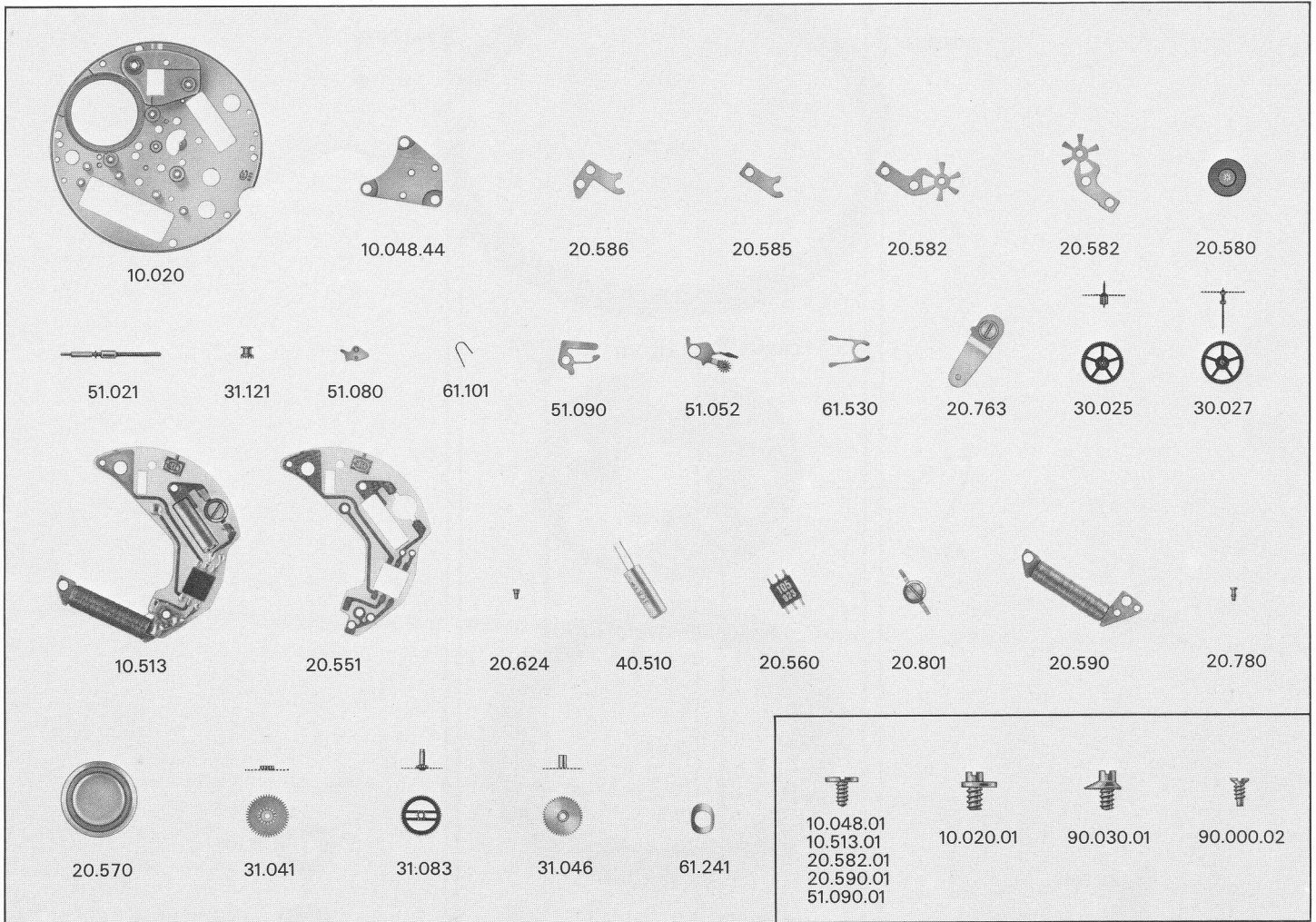

N°	Liste des fournitures	Nr.	Bestandteile	No.	List of materials
10.020	Platine	10.020	Werkplatte	10.020	Plate
10.048.44	Pont rouage 4 rubis	10.048.44	Räderwerkbrücke 4 Steine	10.048.44	Train wheel bridge 4 jewels
20.586	Plaque sous	20.586	Untere Platte	20.586	Lower cap
20.585	Plaque sus	20.585	Obere Platte	20.585	Upper cap
20.582	Stator	20.582	Stator	20.582	Stator
20.580	Rotor monté	20.580	Rotor montiert	20.580	Rotor mounted
51.021	Tige	51.021	Aufzugwelle	51.021	Winding-stem
31.121	Pignon coulant	31.121	Kupplungstrieb	31.121	Clutch wheel
51.080	Tirette montée	51.080	Winkelhebel montiert	51.080	Setting lever mounted
61.101	Ressort de bascule	61.101	Kupplungshebelfeder	61.101	Yoke spring
51.090	Sautoir de tirette	51.090	Winkelhebelraste	51.090	Setting lever jumper
61.530	Ressort de contact	61.530	Kontaktfeder	61.530	Contact spring
20.763	Bride montée	20.763	Bügel montiert	20.763	Bridle mounted
30.025	Roue moyenne	30.025	Kleinbodenrad	30.025	Third wheel
31.041	Roue minuterie	31.041	Wechselrad	31.041	Minute wheel
10.513	Module électronique	10.513	Elektronik-Baugruppe	10.513	Electronic module
20.570	Pile	20.570	Batterie	20.570	Battery
30.027	Roue de seconde	30.027	Sekundenrad	30.027	Second wheel
51.052	Bascule montée	51.052	Wippe montiert	51.052	Yoke mounted
31.046	Roue des heures	31.046	Stundenrad	31.046	Hour wheel
31.083	Chaussée montée	31.083	Minutenrohr montiert	31.083	Canon pinion mounted
61.241	Plaque maintien	61.241	Friktionsfeder für Stundenrad	61.241	Maintaining plate
10.048.01	Vis pont	10.048.01	Brückenschraube	10.048.01	Bridge screw
10.513.01	Vis module électronique	10.513.01	Schraube für Elektronik-baugruppe	10.513.01	Electronic module screw
20.582.01	Vis stator	20.582.01	Stator-Schraube	20.582.01	Stator screw
20.590.01	Vis noyau	20.590.01	Motorkern-Schraube	20.590.01	Core screw
51.090.01	Vis sautoir de tirette	51.090.01	Winkelhebelrasten-Schraube	51.090.01	Setting lever jumper screw
10.020.01	Vis de fixation	10.020.01	Befestigungs-Schraube	10.020.01	Fastening screw
90.030.01	Clef de cadran	90.030.01	Zifferblatt-Schlüssel	90.030.01	Dial key
90.000.02	Vis cadran plat	90.000.02	Zifferblatt-Schraube flach	90.000.02	Flat dial screw

Cal. 888/31

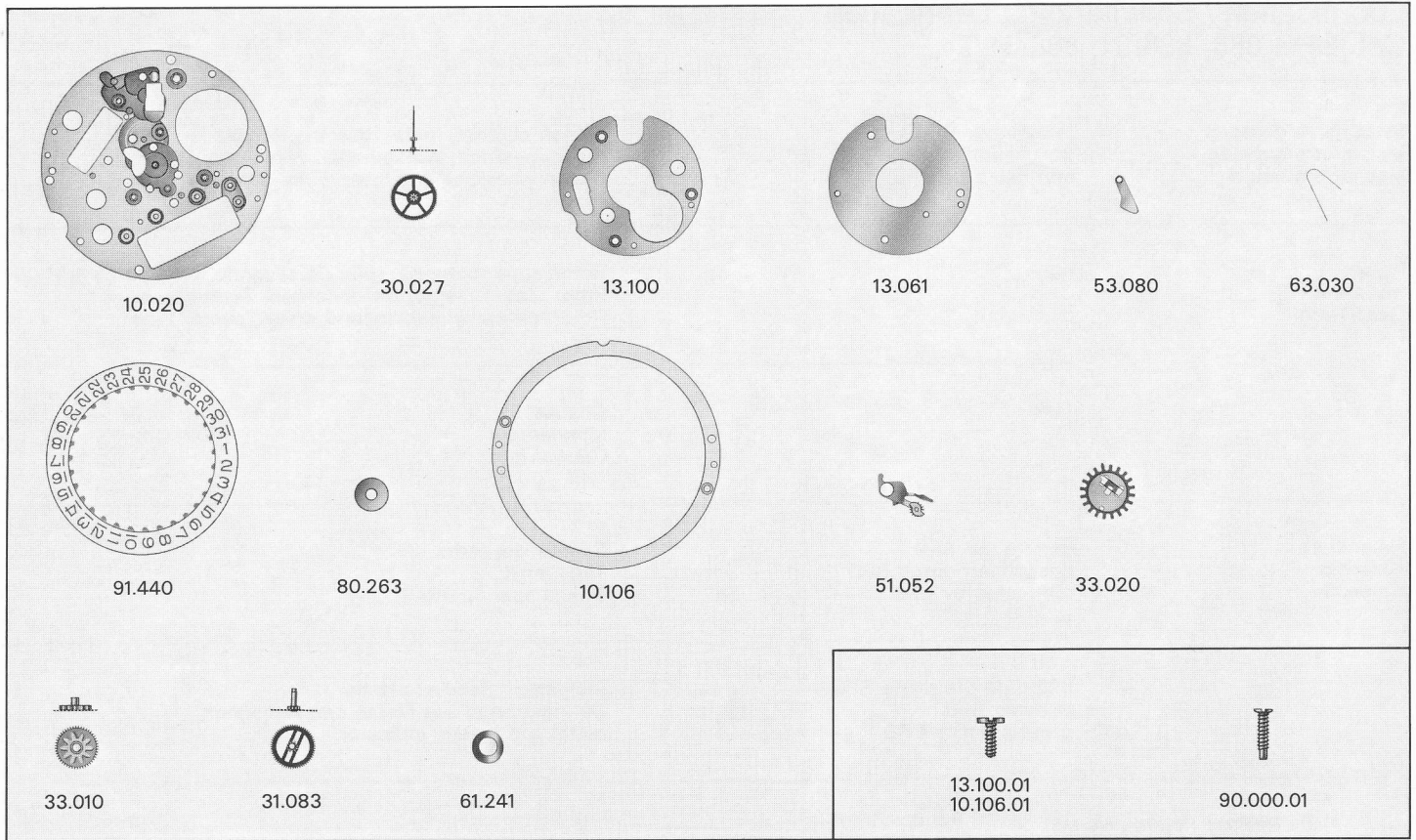

N°	Liste des fournitures	Nr.	Bestandteile	No.	List of materials
10.020	Platine	10.020	Werkplatte	10.020	Plate
30.027	Roue de seconde	30.027	Sekundenrad	30.027	Second wheel
13.100	Plaque de maintien	13.100	Halterplatte	13.100	Maintaining plate
13.061	Support de mécanisme	13.061	Träger für Datummechanismus	13.061	Date mechanism support
53.080	Sautoir de quantième	53.080	Datmraste	53.080	Date jumper
63.030	Ressort sautoir	63.030	Feder für Datmraste	63.030	Date jumper spring
91.440	Indicateur de quantième	91.440	Datumanzeiger	91.440	Date indicator
80.263	Rondelle de maintien	80.263	Haltescheibe	80.263	Maintaining washer
10.106	Support de cadran	10.106	Zifferblatt-Träger	10.106	Dial rest
51.052	Bascule montée	51.052	Wippe montiert	51.052	Yoke mounted
33.020	Roue entraîneuse	33.020	Mitnehmerrad	33.020	Driving wheel
33.010	Roue des heures double denture	33.010	Stundenrad mit Doppelverzahnung	33.010	Double-toothed hour wheel
31.083	Chaussée montée	31.083	Minutenrohr montiert	31.083	Cannon pinion mounted
61.241	Plaque maintien	61.241	Halterplatte	61.241	Maintaining plate
13.100.01	Vis plaque maintien	13.100.01	Halterplatten-Schraube	13.100.01	Maintaining plate screw
10.106.01	Vis support de cadran	10.106.01	Zifferblattstützen-Schraube	10.106.01	Dial rest screw
90.000.01	Vis cadran plat	90.000.01	Zifferblatt-Schraube flach	90.000.01	Flat dial screw

Cal. 888/31/7

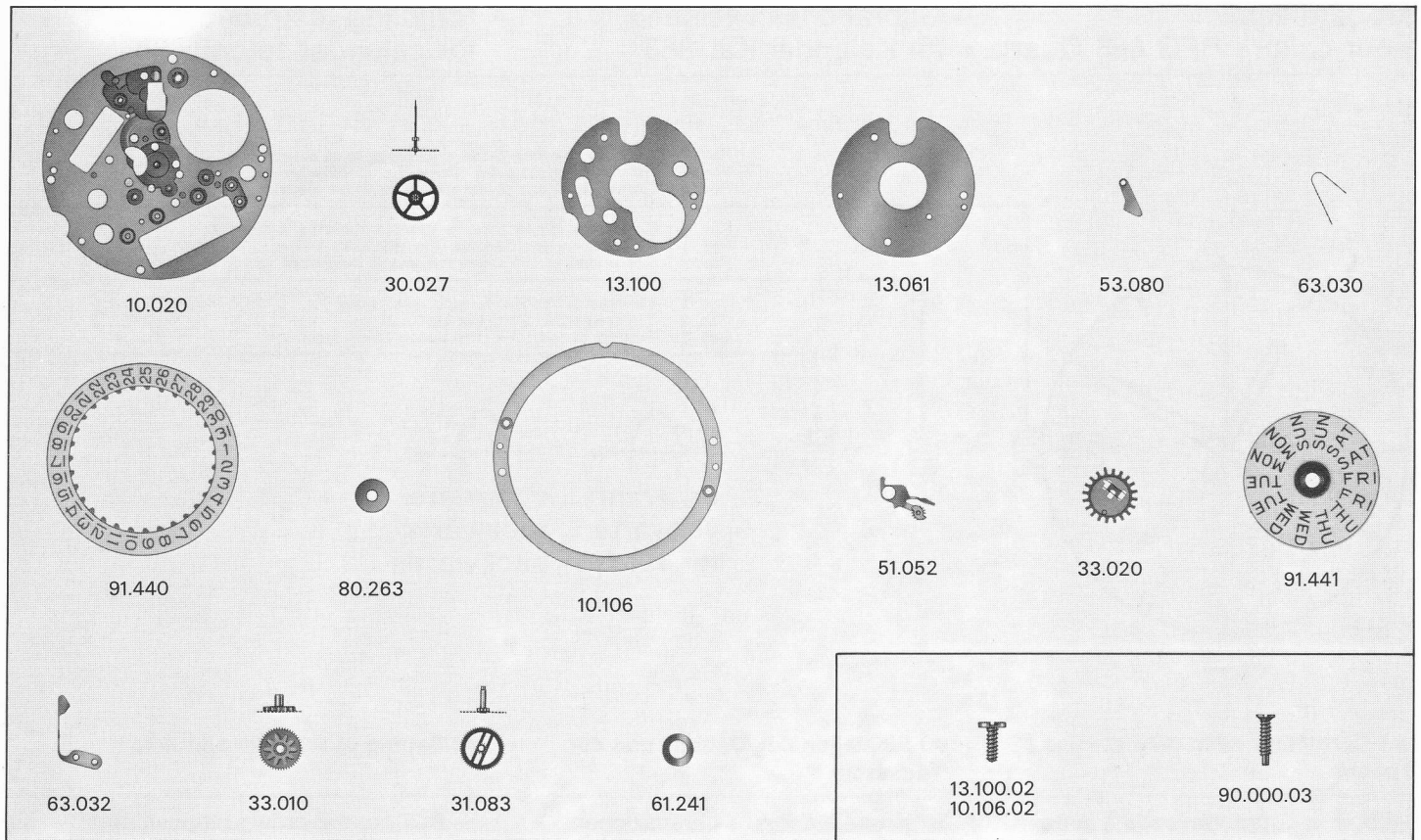

N°	Liste des fournitures	Nr.	Bestandteile	No.	List of materials
10.020	Platine	10.020	Werkplatte	10.020	Plate
30.027	Roue de seconde	30.027	Sekundenrad	30.027	Second wheel
13.100	Plaque maintien	13.100	Halterplatte	13.100	Maintaining plate
13.061	Support de mécanisme	13.061	Träger für Datummechanismus	13.061	Date mechanism support
53.080	Sautoir de quantième	53.080	Daturnaste	53.080	Date jumper
63.030	Ressort sautoir	63.030	Feder für Daturnaste	63.030	Date jumper spring
91.440	Indicateur de quantième	91.440	Datumanzeiger	91.440	Date indicator
80.263	Rondelle de maintien	80.263	Haltescheibe	80.263	Maintaining washer
10.106	Support de cadran	10.106	Zifferblatt-Träger	10.106	Dial rest
51.052	Bascule montée	51.052	Wippe montiert	51.052	Yoke mounted
33.020	Roue entraîneuse	33.020	Mitnehmerrad	33.020	Driving wheel
91.441	Etoile des jours montée	91.441	Tagesanzeiger	91.441	Day indicator mounted
63.032	Ressort sautoir des jours	63.032	Feder für Tagesraste	63.032	Day jumper spring
33.010	Roue des heures double denture	33.010	Stundenrad mit Doppelverzahnung	33.010	Double-toothed hour wheel
31.083	Chaussée montée	31.083	Minutenrohr montiert	31.083	Cannon pinion mounted
61.241	Plaque maintien	61.241	Halterplatte	61.241	Maintaining plate
13.100.02	Vis plaque maintien	13.100.02	Halterplatten-Schraube	13.100.02	Maintaining plate screw
10.106.01	Vis support de cadran	10.106.01	Zifferblatt-Träger-Schraube	10.106.01	Dial rest screw
90.000.03	Vis cradan plat	90.000.03	Zifferblatt-Schraube flach	90.000.03	Flat dial screw