

Catalog No. A2-1 ~ A2-2
 カタログ番号 A2-1 ~ A2-2

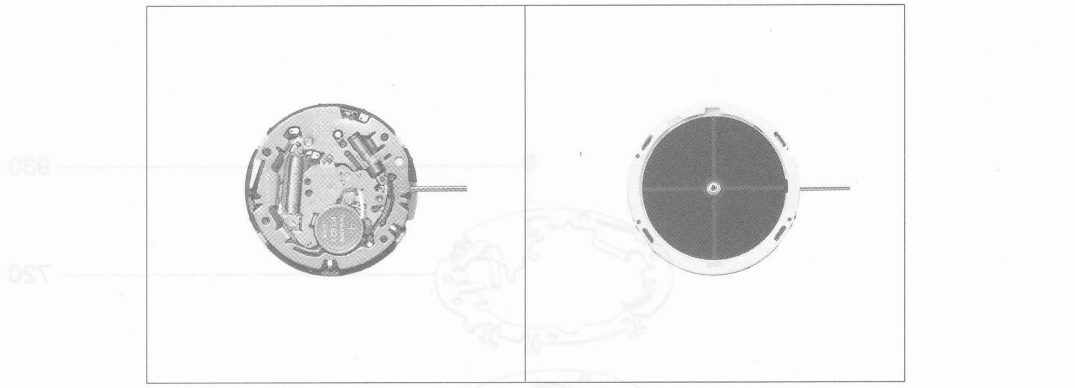

Caliber No. A234A
 キャリバー No. A234A

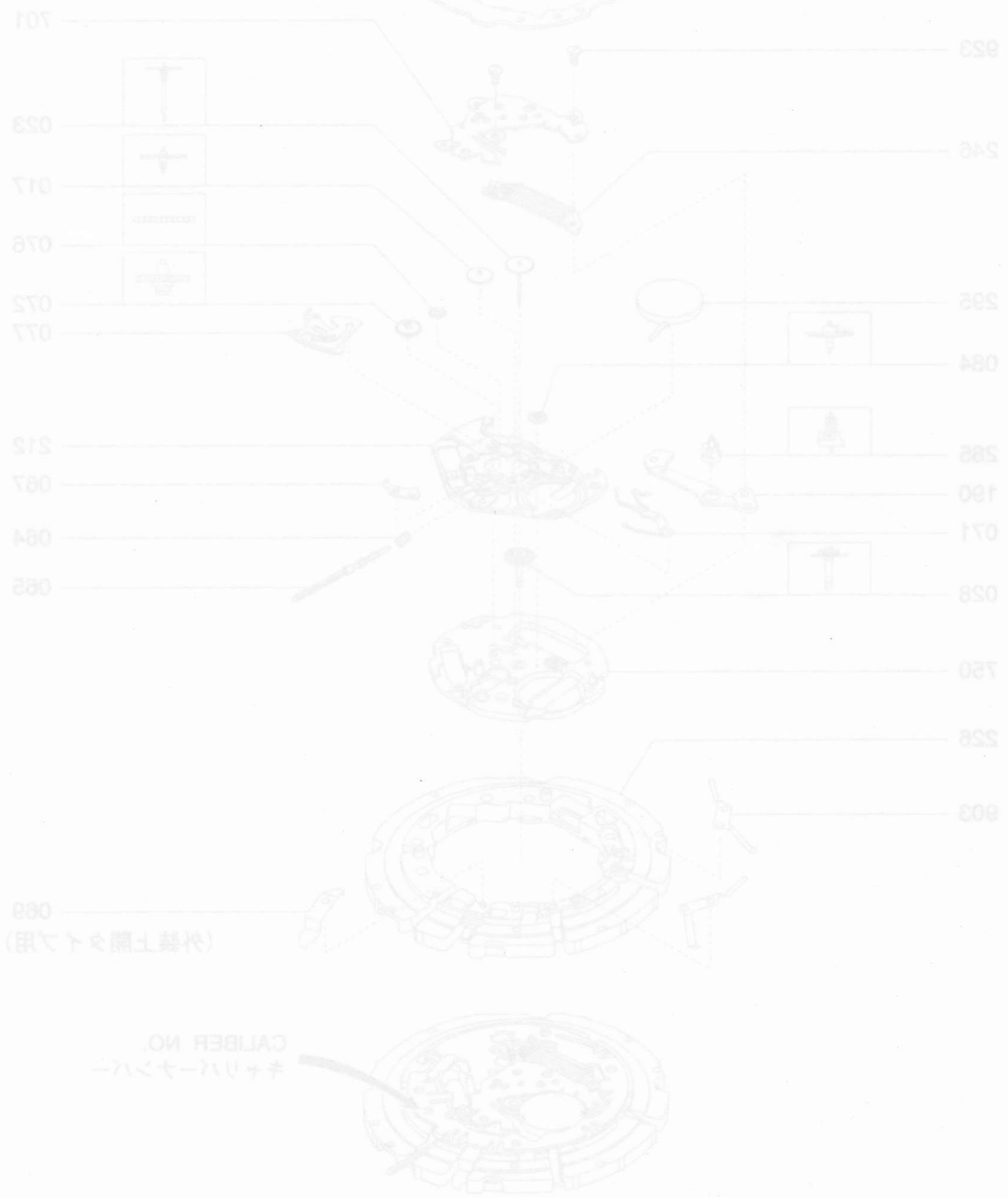

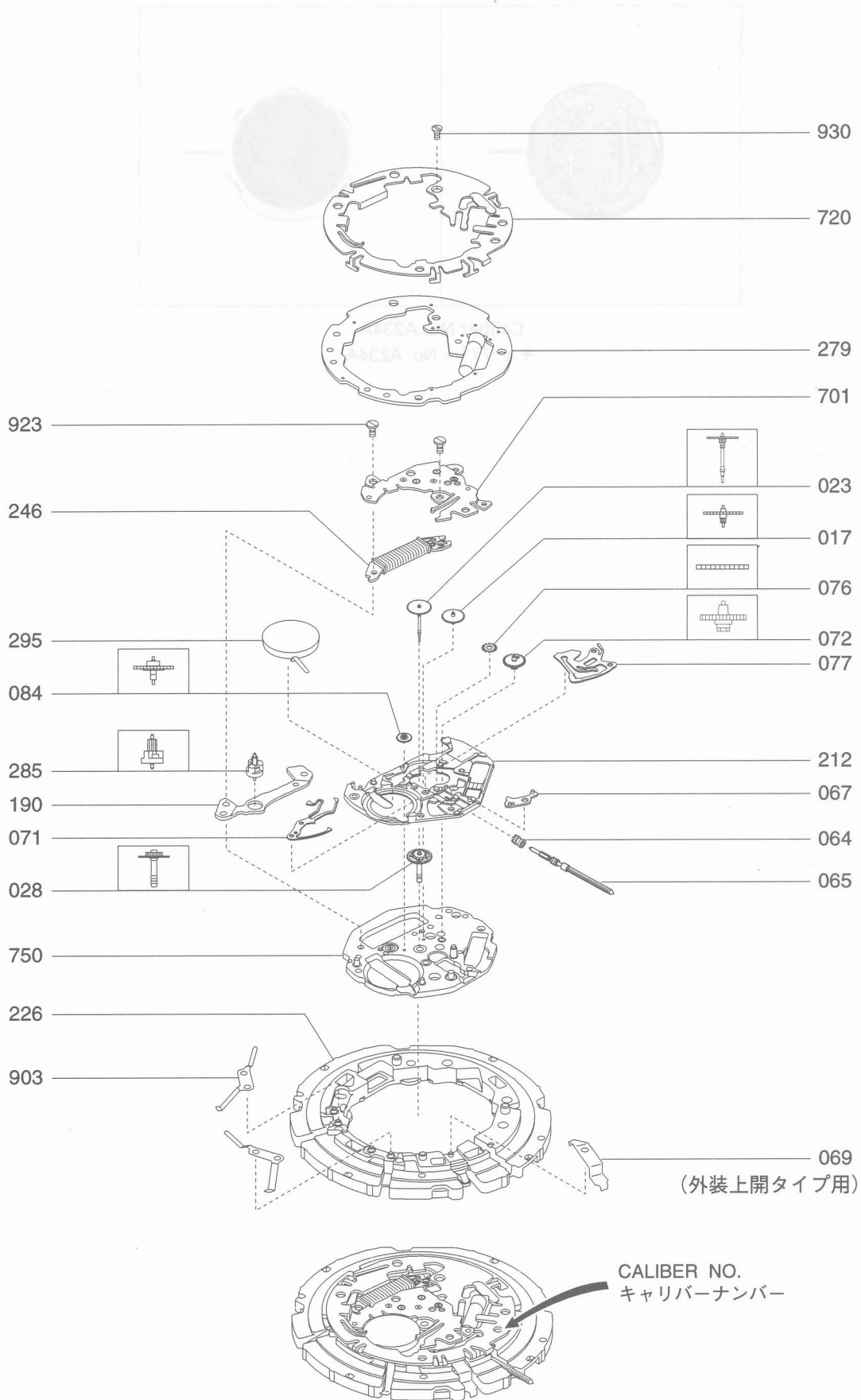

Catalog No. A2-1
カタログ番号 A2-1

Part No. 部品番号	キャリバーNo. 石数 部品名称	Caliber No. No. of jewels Name of parts	A234A	A239A	A270M				
			00	00	00				
701	輪列受	Train wheel bridge	A20	○	C11				
017	三番車	Third wheel and pinion	149	○	○				
023	四番車	Fourth wheel and pinion	304 (306)	○	304				
028	中心車	Cannon pinion with driving wheel	264 (266)	○	264				
064	ツツミ車	Clutch wheel	79	○	○				
065	巻真	Setting stem	499 (471)	○	○				
065	巻真(大型ケース用)	Setting stem (For large size case)	495 (473)	○	○				
067	オシドリ	Setting lever	194 (168)	○	194				
071	カンヌキ	Yoke	132	○	○				
072	日ノ裏車	Minute wheel and pinion	121	○	○				
076	小鉄車	Setting wheel	64	○	○				
077	裏押工	Setting lever spring	135 (129)	○	○				
084	五番車	Fifth wheel and pinion	70	○	○				
190	完成ヨーク	Stator	152	○	○				
212	巻真スペーサー	Spacer for setting stem	243 (235)	○	○				
226	回路支持台	Supporter for plate complete	419	○	○				
226	ソーラーセル支持枠	Support ring for solar cell	421	○	○				
233	二次電池絶縁板	Insulator for secondary battery			481				
234	二次電池押さえ板	Secondary battery strap			956				
246	完成コイル	Coil unit	182 (168)	○	○				
279	複合回路	Unit of electronic circuit	B05 (A73)	○	B05				
285	完成ローター	Rotor	175	○	○				
295	二次電池	Secondary battery	37	○	44				
720	回路支持板	Circuit unit supporter	348	346	383				
750	完成地板	Metal plate	C32 (B64)	○	C32				
903	ソーラーセル接続バネ	Contact spring for solar cell	178	○	○				
923	輪列受ねじ	Screw for train wheel bridge	112 (106)	○	○				
930	コイルネジ	Screw for coil unit	64	○	○				

Part No. 部品番号	Caliber No. 口径	Name of parts 部品名	Part No. 部品番号	Caliber No. 口径	Name of parts 部品名
701	90	Train wheel bridge	701	90	Train wheel bridge
702	90	Third wheel and pinion	702	90	Third wheel and pinion
703	90	Fourth wheel and pinion	703	90	Fourth wheel and pinion
704	90	Canon pinion (for driving wheel)	704	90	Canon pinion (for driving wheel)
705	90	Train wheel	705	90	Train wheel
706	90	Setting stem	706	90	Setting stem
707	90	Setting stem (for 1000)	707	90	Setting stem (for 1000)
708	90	Setting lever	708	90	Setting lever
709	90	Yoke	709	90	Yoke
710	90	Million wheel and pinion	710	90	Million wheel and pinion
711	90	Setting wheel	711	90	Setting wheel
712	90	Setting lever spring	712	90	Setting lever spring
713	90	Flip wheel and pinion	713	90	Flip wheel and pinion
714	90	Stator	714	90	Stator
715	90	Spacer for setting stem	715	90	Spacer for setting stem
716	90	Supporter for plate complete	716	90	Supporter for plate complete
717	90	Support ring for solar cell	717	90	Support ring for solar cell
718	90	Insulator for secondary battery	718	90	Insulator for secondary battery
719	90	Secondary battery strap	719	90	Secondary battery strap
720	90	Coil unit	720	90	Coil unit
721	90	Unit of electronic circuit	721	90	Unit of electronic circuit
722	90	Bator	722	90	Bator
723	90	Secondary battery	723	90	Secondary battery
724	90	Cross unit supporter	724	90	Cross unit supporter
725	90	Base plate	725	90	Base plate
726	90	Contact spring	726	90	Contact spring
727	90	Screw for train wheel	727	90	Screw for train wheel
728	90	Screw for coil unit	728	90	Screw for coil unit

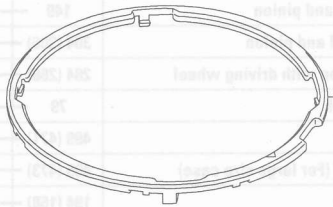

226

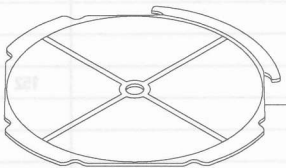

310

078



075

